

MEET AT MATFEN

MEETING AND EVENTS



MATFEN HALL

COUNTRY HOTEL, SPA & GOLF ESTATE



53 bedrooms
ranging from luxury
to classic



Six exclusive dining
experiences that leave
a lasting impression

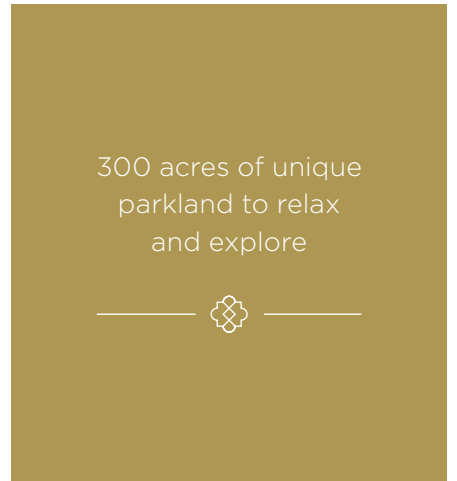

300 acres of unique
parkland to relax
and explore



27 hole
championship
golf course

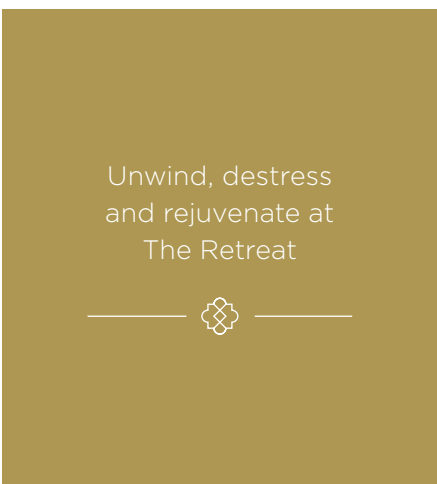

Unwind, destress
and rejuvenate at
The Retreat



16 metre swimming
pool and advanced
fitness area





WORK, REST AND PLAY

FIVE STAR EXPERIENCE, ATMOSPHERE AND SPACE

Nestled in the heart of historic Northumberland, just 18 miles from vibrant Newcastle upon Tyne, and with easy access to airports and motorways, our magnificent country estate boasts an impressive hideaway for creative corporate events.

With over 300 acres of unique parkland, Matfen Hall offers a refreshing change of pace and scenery that suits every occasion. Forget boring meetings in windowless spaces our bright, beautiful rooms open out onto perfectly manicured gardens, providing employees and guests with the escapism they need to disconnect, innovate and create.

With a choice of six flexible spaces, 53 luxurious bedrooms, five premium dining destinations, The Retreat and a championship golf course to enjoy, our grand estate is uniquely positioned to deliver bespoke, stand out experiences that engage employees before, during and after your event.

Whether it's an outdoor brainstorming session or a yoga class on our beautiful lawns, Matfen Hall, with over 50 years experience in exceptional hospitality, is guaranteed to deliver something extra special.

IDEAL FOR

Corporate and Board Meeting



Private Dining and Celebrations



Product and Brand Launches



Car Launches



Team Building



OUR SPACES





1



2



3

1. THE SAPPHIRE

Accommodating up to 18 people, the light and airy Sapphire offers an ideal setting for corporate meetings and intimate celebrations. Food and drinks menus - ranging from decadent three-course dinners to cocktails and light bites - can be created to complement every occasion.

2. THE MORNING ROOM

Located in the heart of the Great Hall, The Morning Room is distinguished by its original oak panelling, giving it an intimate, informal atmosphere, as well as its large glass windows that offer plenty of natural light and views across our enchanting 300 acre estate.

3. LE JARDIN HOLLANDAISE

Overlooking stunning views of our championship golf course, Le Jardin Hollandaise offers a unique secluded feel, but with a dramatic view. Ideal for pre-dinner drinks in conjunction with our large event spaces, or for stand-alone celebrations and al fresco dining.



4. CLOISTERS BAR

Take your celebrations underground with a private bar and DJ booth in Matfen Hall's atmospheric Cloisters Bar. Tucked away in the cellars of the original stately home, The Cloisters Bar offers complete privacy.

5. THE ORANGERY

Perfectly positioned to overlook our estate's vast parkland, the beautiful glass-paned walls of the Orangery boast a light and bright setting to suit your every occasion. Complete with direct access to Le Jardin Hollandaise and private bar facilities.

6. THE TERRACE

Situated in our vast, stunning parkland, this unique setting is perfect for enjoying a dose of fresh air on your morning coffee break, or for indulging in delicious alfresco dining beside the beautiful backdrop of Matfen Hall.



FLOOR PLANS AND CAPACITIES

ROOM NAME	DIMENSIONS	THEATRE	CABARET	BANQUETING	OUTDOOR DRINKS & DINING	DRINKS & DANCING
1. The Sapphire	6.5m x 4.8m	-	-	18	-	-
2. The Morning Room	18m x 7m	60	40	100	-	-
3. Le Jardin Hollandaise	-	-	-	40	60	-
4. Cloisters Bar and Lounge	-	-	-	-	-	120
5. The Orangery	10.1m x 5.6m	-	-	20	-	-
6. The Terrace	-	-	-	-	100	-

GROUND FLOOR

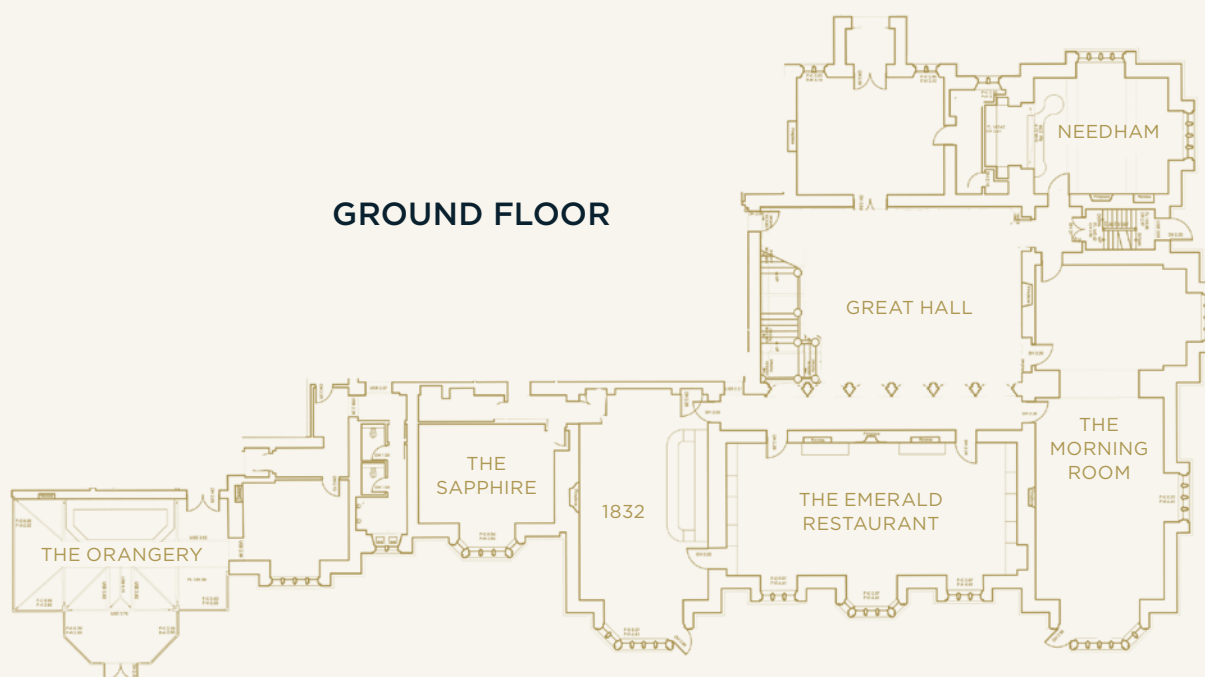

BASEMENT

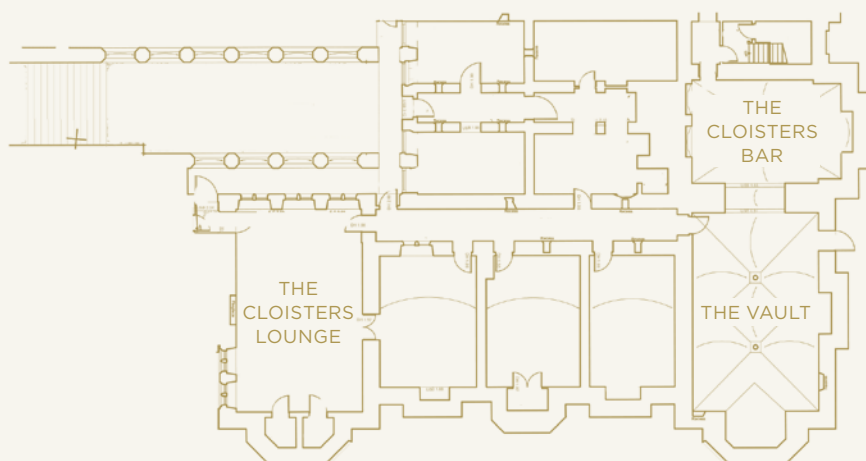



OUR FACILITIES



FOOD AND DRINK

EXCEPTIONAL DINING EXPERIENCES

Let our expert chefs spoil your guests with specially tailored menus and exceptional cuisine.

There's nothing quite like a group dinner to bond your colleagues or celebrate an important event. Whether it's a working lunch in the Orangery, a decadent three-course dinner in the Emerald Restaurant, a BBQ on the Terrace, or an indulgent canapé selection, our bespoke dining options are guaranteed to leave a lasting impression.





COCKTAIL MASTERCLASS

Whether you like yours on the rocks, shaken or stirred, unleash your inner mixologist and learn how to be a cocktail master!



THE RETREAT

ESCAPE TO LUXURY

With an emphasis on mind, body, and spirit, The Retreat at Matfen Hall is the perfect place in which to unwind and rejuvenate, away from the stresses of everyday life.

After a busy day in the meeting room guests can enjoy a dip in our glass-walled pool or time spent unwinding in our range of thermal suites, each complete with different temperatures, humidities and aromas. Our relaxation rooms will help you destress, or why not indulge in luxurious spa Treatments and Rituals?

IDEAL FOR RELAXING

- Swimming Pool
- Aromatherapy Room
- Steam Room
- Sauna
- Ice Cold Bucket Shower
- Monsoon Shower
- Ice Fountain
- Fitness Area
- Treatments and Rituals



YOGA WORKSHOPS

Step away from the meeting room and take time for yourself and your team with our physical and mental well-being boosting Yoga sessions.

GOLF COURSE

THE COMPLETE
GOLFING EXPERIENCE

At Matfen Hall, we believe corporate golf days should be geared towards getting out of the office, relaxing and having fun together.

Set in over 300 acres of parkland with established burns and woodland, our 27-hole course is rated as one of the finest in North East England.

With courses as beautiful as the stunning scenery that surrounds them, Matfen Hall Golf Course is the perfect setting for forgetting the hierarchy and unleashing your competitive spirit as you enjoy each other's company. With a Par-3 short course, golf driving academy and driving range, you won't be short of things to do.



GOLF COACHING CLASSES

Whether you're aiming for the PGA Tour or just want to learn a new set of skills, why not treat your employees to one of our group golf coaching classes?



OUR ROOMS



GREAT HALL SUITES

Luxury, elegance and exceptional attention to detail lie at the heart of these nine generously-sized rooms. Featuring Emperor sized beds and uniquely-designed soft furnishings, as well as marble bathrooms and walk-in showers, these rooms are the ultimate choice for those seeking a luxurious experience.

GREAT HALL PREMIUM

Boasting unrivalled views of our breathtaking surroundings, our six Premium Rooms exude class, refinement and sophisticated comfort. Located in the Great Hall beneath original high ceilings, these rooms benefit from luxurious marble bathrooms, beautiful large windows, and exquisite interior design.

- Located in the historic Great Hall
- Magnificent views
- Marble bathrooms
- Penhaligon's of London toiletries
- Access to The Retreat
- High-speed connectivity
- Valet parking



OLD HALL CLASSIC DOUBLE/TWIN ROOM

Filled with character and natural light, our Classic Rooms are furnished with everything you need to enjoy a magnificent stay. Each room perfectly captures the balance between traditional comfort and contemporary elegance to ensure your visit to Matfen Hall is memorable.



OUT AND ABOUT

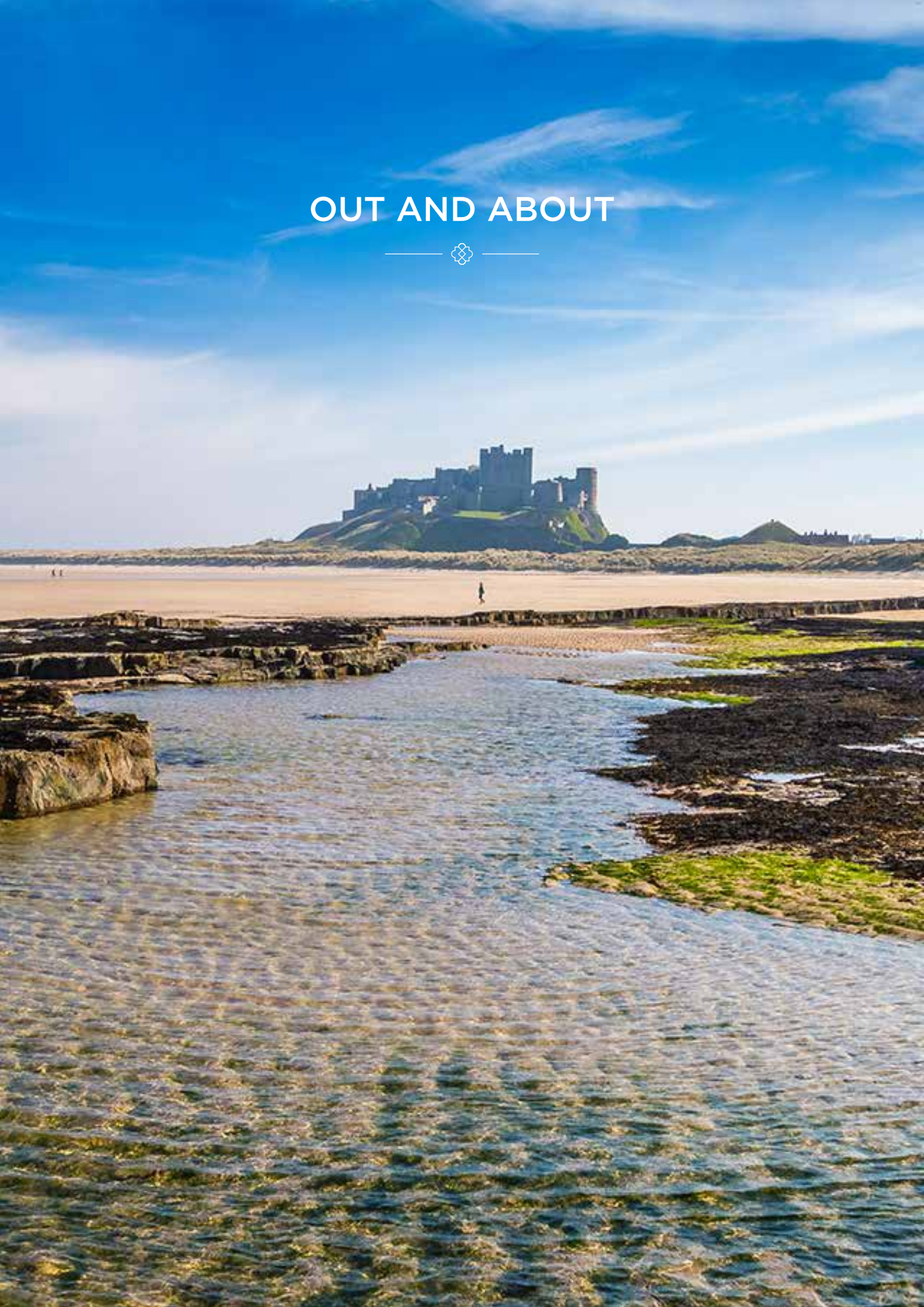



While just a short distance away from vibrant Newcastle upon Tyne, our unique setting is far enough away from busy city life. From outdoor pursuits on our 300 acre estate to creative, action-packed and code-cracking events just a stone's throw away, Matfen Hall is the perfect setting to get your team bonding and working together in a whole new way.

THINGS TO SEE

- Chesters Roman Fort
 - Vindolanda
 - Hadrian's Wall
 - Hexham Abbey
 - Sycamore Gap
 - Kielder Water and Observatory
 - Otterburn
 - Aydon Castle
 - Lindisfarne
-

THINGS TO DO

- Fishing
 - Horse Riding
 - Falconry Days
 - Clay Pigeon Shooting
 - Stargazing
 - Archery
 - Cycling
 - Go Ape
 - Quad Biking
-





MATFEN HALL

COUNTRY HOTEL, SPA & GOLF ESTATE

MATFEN HALL, MATFEN, NORTHUMBERLAND NE20 0RH
01661 886 500 INFO@MATFENHALL.COM